

Port Discovery Children's Museum provides experiences which ignite imagination, inspire learning and nurture growth through play!

Help Us Help Others as a Friend of Port Discovery!

Helping children achieve a sense of accomplishment through play is part of the mission of Port Discovery. By becoming a FRIEND of Port Discovery, you can help children and families who cannot afford to visit the Museum become members.

Through Port Discovery's Family Access Program, you can purchase a family membership for \$95 and help a less fortunate family IMAGINE! PLAY! LEARN! GROW! all year at the Museum.

Please support the Family Access Program today with a tax-deductible gift to Port Discovery and help an underserved family benefit from all that Port Discovery has to offer.

To donate, please visit portdiscovery.org or pick up a Give! brochure located throughout the Museum.

Wonderful Wednesdays!

Bank of America

Enjoy special arts programming designed for younger children (ages 2-7). For information, call 410.864.2678.

Don't miss the Port Discovery

Super Awesome, **EXTRA FUN & EDUCATIONAL Gift Shop!**

(Located in the 1st floor lobby)

Become a MEMBER today and receive:

- Unlimited access with a year long admission
- The Port Discovery Newsletter mailed directly to you
- Invitations to special events
- Express entry and much more!

For more information, visit the Box Office or call 410.864.2667.

★ Photography Policy: **BABY, you're a star!**

Port Discovery occasionally photographs children and family programs for future promotional purposes. If you do not want your child photographed, please notify Guest Services.

Need to reconnect with your chaperone, child or group? An associate in a green apron can help you find them!

PORT DISCOVERY Children's Museum

Museum Directory

THROUGH MAY 17TH

Joshua's Journey

A Black Cowboy Rides the Chisholm Trail

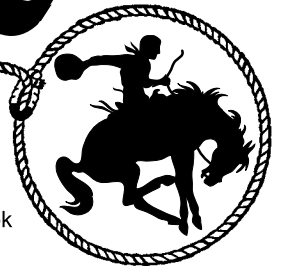

Based on the Dear America / My Name is America book "The Journal of Joshua Loper: A Black Cowboy"

SCHOLASTIC

scholastic.com/dearamerica

A new interactive exhibit featuring several themed areas that teach children about life on the trail. Rope a calf! Ride a life-sized bucking bronco! Role-play at the authentic chuck wagon! And more!

Joshua's Journey was created by the Fort Worth Museum of Science and History in partnership with Scholastic Entertainment, the Youth Museum Exhibit Collaborative (YMEC), The National Cowgirl Museum and Hall of Fame and Cattle Raisers Museum.

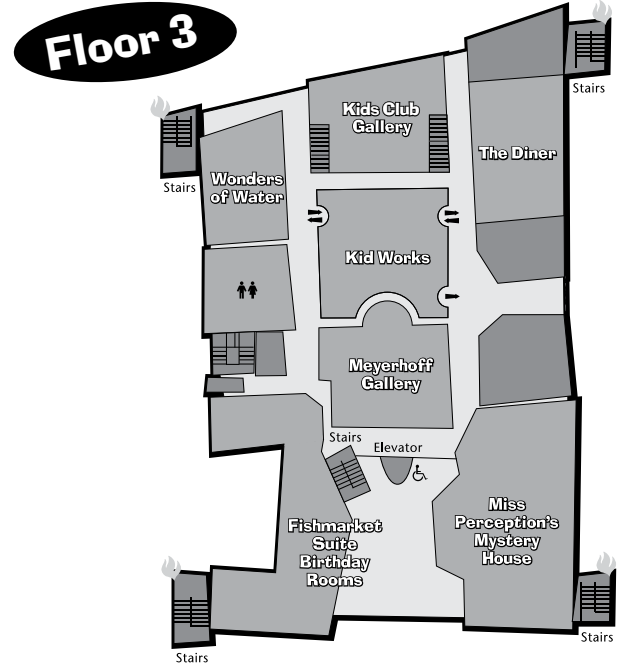
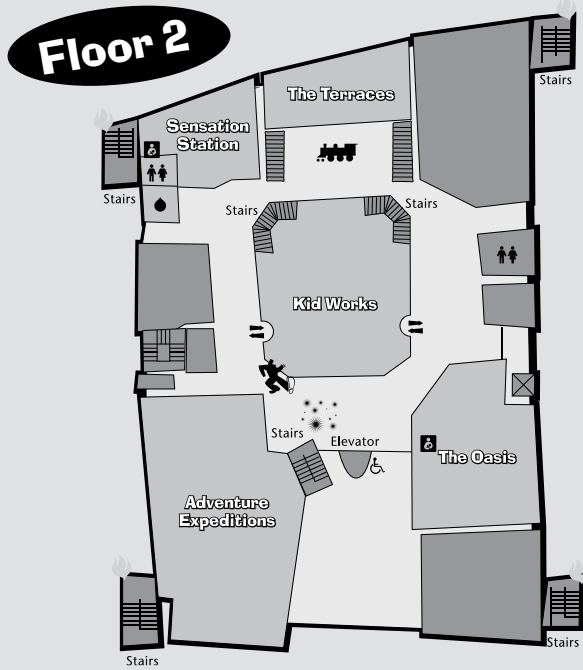

KidWorks (floors 1-3) Ages 4+
 KidWorks is a 3.5 story, "up-only" climbing experience with entrances and exits on all 3 levels. Museum associates with radios are stationed within KidWorks. Chaperones are strongly encouraged to climb. **If not climbing, place a chaperone at each of the 2nd & 3rd floor exits. Use the map to plan a meeting time and place.**

The Farm
 Harvest vegetables, operate a silo, play chicken twister, groom a horse's tail and even milk a cow.

Show' Em a Poem
 Create your own poem using words on our poem wall. Sort words by color or choose a word that begins with the first letter in your name!

Soccer Field
 Roll or kick the ball into the goal. Race, jump, or hop. Bounce, roll, or throw the ball in a circle. Even try a crab walk while you're here!

Studio Workshop Ages 4 and up
 Programs change every four months with activities appropriate for younger children. Sign-up is usually required for Studio Workshop.

R&D DreamLab Ages 6 and up
 As part of the **Joshua's Journey** experience, discover the relationship between cowboys and the pioneers and build homesteads of your own using Mega Logs™ (**Joshua's Journey** opens January 17).

MPT Studio
 Check "Cool Things to Do" to see a schedule of the day's programs, including Shadow Charades, Scrape, Rattle & Drum and Karaoke. Activities may require sign-up.

The Pier
 Need a place to eat your snacks? We have tables available on a first come, first serve basis. Vending machines available.

Royal Farms Convenience Store and Fill'er Up Station
 Come explore our newest, fun-filled exhibit where children can learn how to make healthy choices in a convenient world in an interactive replica of a Royal Farms store and gas station!

Train Station
 Find the car with the train whistle, take a ride, and sell tickets at the ticket booth. All aboard!

The Terraces
 Load and unload crates to and from the marketplace and train. Just "up the road," shop for farm-fresh fruits and veggies at the Roadside Market.

Wonder Widgets
 Become a worker on an assembly line and fill in the shapes on the moving conveyor belt. Compete one-on-one or in teams to see who can earn the most points.

Dress, Drum, & Jam
 Play with rhythms and dress-up in costumes.

Follow the Colors
 Travel with the moving lights as they twirl across the floor and up the wall.

Adventure Expeditions Ages 7+
 Travel back in time and embark on an interactive exploration of 1920's Egypt! Be sure to pick up a map by the door before you enter.

The Oasis
 A creative space and quiet zone for young children featuring toys, games and books. Circle Times are held Tuesday-Friday at 11:30 am, Saturday 11 am, 12 am, and 1 pm, and Sundays at 3:30 pm. Times may vary.

Sensation Station Ages Birth - 4
 Build a castle, discover textures, read a story, and more in this exhibit created for our youngest guests. There's even a mini KidWorks!

Special Exhibition in the Meyerhoff and Kid Club Galleries: Joshua's Journey through May 17
 This interactive, bilingual exhibit is based on the Scholastic Dear America®/My Name is America® Book, *The Journal of Joshua Loper: A Black Cowboy*.

Miss Perception's Mystery House Ages 6+
 Use all of your senses as you pick up clues and follow leads to discover the whereabouts of the missing Baffeld family. Find out: What happened? Why did it happen and where are they now?

The Diner
 Swing by The Diner to "cook" and serve up realistic play food and listen to cool tunes on the real jukebox.

Wonders of Water!
 Splash around in our newest exhibit featuring Water Chimes, Plumber's Park, a Stream Table, Bubble Hoop, and more! Raincoats and Crocs™ and a Body Dryer are available.

Exhibits that are boxed are specially designed for Early Learners ages 2-7

- 🗑️ Port Discovery Gift Shop
- 🚰 Water Fountains
- 🚰 Security
- 🚰 Nursing Station
- 🚻 Restrooms
- 🚰 First Aid
- 🚻 Family Restroom
- 🚰 Coat Room
- 🚰 Wheelchair Accessible
- 🚰 Fire Exits/Stairs
- 🚰 Enter/Exit